

• To Be Determined By
Curb Manufacturer

Plan View

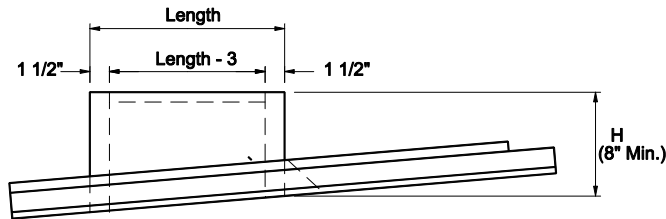

Side View

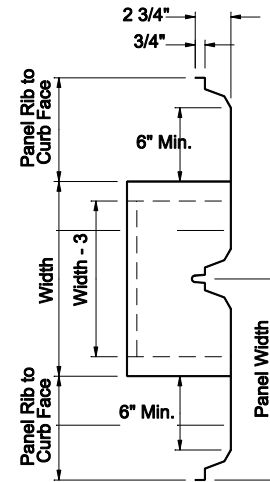

End View

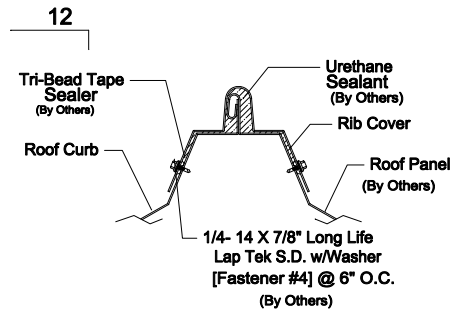

Rib Cover Attachment

* Recommended for use on New Roof only

Standard Requirements

- * .080 Aluminum Construction
- * Corners Mitered and Welded Watertight
- * Welded Cap Cells (Fixed or Loose)
- * Integral Water Diverter
- * 8" Minimum Curb Height
- * 1 1/2" Thick Fiberglass Insulation
- * Under - Over Application
- * Rib to Rib Application
- * Rib Covers - Full Length Plus 1'-0"
- * 20 Year Material and Fabrication Warranty from Curb Manufacturer

Options

- * Galvanized, Galvalume, Stainless Material on non warranty curb only
- * Metal Liner
- * Damper Shelf
- * Decorative Enamel Finish on non warranty curb

MRSR-T Style may be required for trapezoidal Standing Seam Panels by following manufacturers

- * MBCI
- * American Buildings
- * A & S Building Systems
- * Ceko Building Systems
- * Heritage Building Systems
- * Mesco Building Solutions
- * Metallic Building Company
- * Star Buildings
- * Robertson Building Systems
- * Steel Systems
- * Steel Building dot Com
- * Mid - West Steel Building Company
- * All American Systems
- * Garco Building Systems

Specifications and Dimensions

Reference	Qty	L (Pitched)	W	H	Pitch	Options

Roof Panel Information

Manufacturer	Type	On Center



6532 TOWER LANE, CLAREMORE, OK. 74019
Phone: 800-728-3278 Fax: 800-203-1998
(A Division of Acme Mfg. Corp.)

PROJECT	CONTRACTOR
LOCATION	SUBMITTED BY
ARCHITECT	DATE
ENGINEER	PO#